

TO OPEN

Press Secondary Lock Button to release Handle

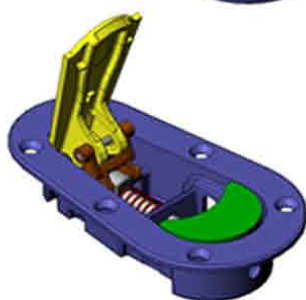

Lift Handle (retracting shear pin out of strike, releasing panel from structure)

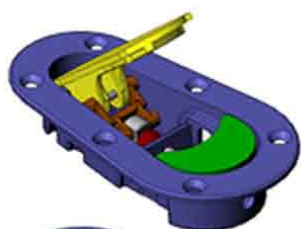

TO CLOSE

(locate panel over strike)
Close Handle and latch to Secondary Lock Button.



AeroCatch in closed position
Handle latched to Secondary Lock Button, Shear Pin located through strike

