



P.O. Box 1719
 Corona, CA 92878
 Support: 877-512-8111
 www.aFeilters.com

Kit Part #	54-10451/10441
Make:	BMW
Model:	330i, 328i and 325i E46
Engine:	L6-3.0L, 2.8L and 2.5L
Year:	1999-2005

Tools Required	1/4" socket, nut-driver 10mm socket or wrench Ratchet and extension Med flat screwdriver 4mm allen wrench
Part List:	1 Filter part # 24-91021 (Replacement Filter) 1 M6 nut 1 M6 washer 8 M6 x 1 x 10mm button head 2 Spring clips 1 Billet adapter 1 Filter shield 1 Filter shield cover

Intake Kit Installation Instructions: BMW 330i/328i/325i E46

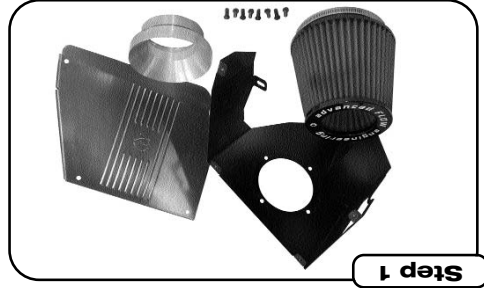

Step 1 Complete kit with parts.



Step 2 Complete stock intake.

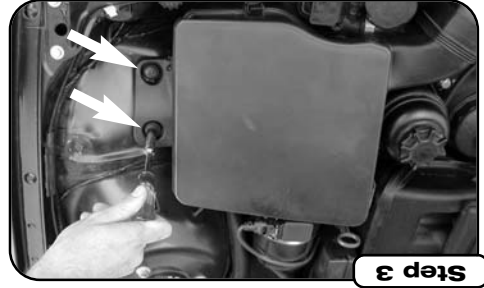

Step 3 Remove two screws with 10 mm socket or wrench.

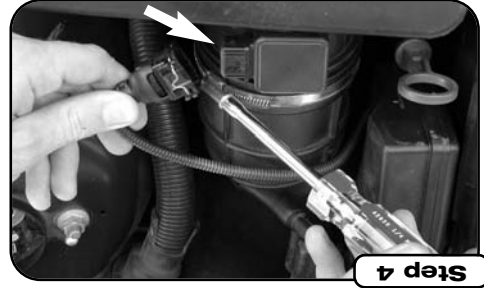

Step 4 Remove mass flow sensor plug and hose clamp (1/4" nut driver)



Step 5 Remove OE air box from vehicle.



Step 6 Remove rubber cushion at bottom of the fenderwell.

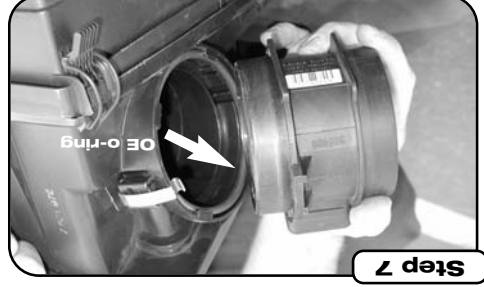

Step 7 Remove the mass flow sensor from OE air box, and carefully pull out o-ring to save and re-use.

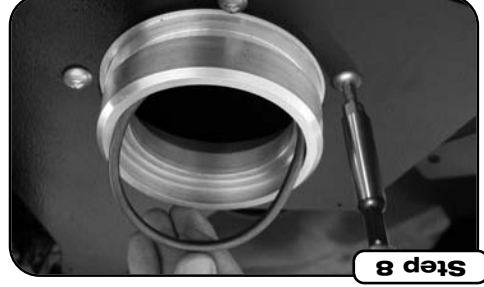

Step 8 Install the billet aluminum adapter to the shield. Use the M6 button heads supplied.



Step 9 Install mass air flow sensor, tighten clamp with 1/4" nut driver and connect mass flow sensor plug.



Step 10 Attach supplied spring clips onto mass flow sensor. Insert hooked end into slotted section on mass flow sensor.



Step 11 Attach stock intake snorkel onto side of shield,



Step 12 Install shield into vehicle, attach snorkel, and slip on mass flow sensor and attach spring clips.

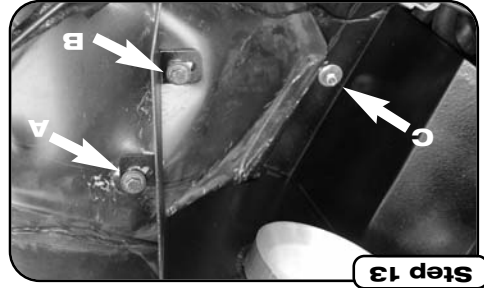

Step 13 Once shield is in place replace the two stock screws A & B (10mm) and use supplied washer and nut C (10mm).

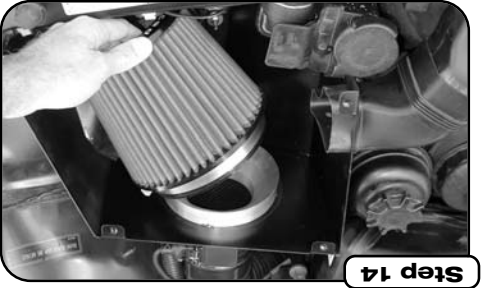

Step 14 Attach filter to adapter and tighten clamp.



Step 15 Make sure all hoses and clamps are tight and that all electrical components (if applicable) are secure. Check and retighten connections and filter after a few hours of operation.

Note: Filter Cleaning and Re-oiling: When cleaning your aFe filter, be sure to use only aFe's "Restore Kit" (aFe P/N: 90-50001 blue oil aerosol, or aFe P/N: 90-50501 blue squeeze bottle oil). Filter Replacement: PN: 24-91021 (black w/blue media)